

# School Concept and Pre-Application Information

(Fall 2024)

**KIU Academy - NISEKO**

For 2025-26 Entrants  
(Inaugural Cohort)



**KIU Academy - NISEKO**

北海道虻田郡ニセコ町元町56-3

TEL: 090-4295-1835 (1-5 PM on Mon-Thu)

Email: [niseko@kyotoiu.ac.jp](mailto:niseko@kyotoiu.ac.jp)

Web: [niseko.kyotoiu.ac.jp](http://niseko.kyotoiu.ac.jp)



Tuition and Fees for 2025 - 2026			
	All grade levels	Payment Options	Type
<b>Application Fee</b>	¥ 25,000	Single payment at the time of enrollment	One Time
<b>Entrance Fee</b>	¥300,000	Single payment at the time of enrollment	One Time
<b>Facilities Fee</b>	¥200,000		Annual
<b>Tuition</b>	¥1,200,000	Installments available (By Year, Term, Month)	

Payment schedule:

- Application Fee, Entrance Fee, Facilities Fee & Tuition → Payment schedule pending prefectural approval.

Tuition Payment Options					
	Time of Enrollment	Amount	Payment Deadlines		
			1st Payment	2nd Payment	3rd Payment
Annual	Spring	¥1,200,000	February 25	-	-
By Term (appx. 5% installment fee)	Spring	¥420,000	February 25	July 25	November 25
	Fall		July 25	November 25	-
	Winter		November 25	-	-
By Month (appx. 10% installment fee)	Spring	¥110,000	February 25	25th of every month	
	Fall	¥125,000	July 25		
	Winter	¥146,000	November 25		

Other points to note:

- Early Action Discount: ¥200,000 will be deducted from the entrance fee for early-action entrants.
  - To qualify for the early action discount, applicants must 1) undergo the pre-application (September 6 to October 25, 2024) and 2) make the required payments within two weeks of the payment notification.
- English / Bilingual Ability Discount:
  - Tier A: ¥200,000 will be deducted from the annual tuition if your child has native English ability (able to succeed in academic English at or within one year of grade level).
  - Tier B: An additional ¥50,000 will be deducted from the annual tuition if your child is fluent in Japanese.
- Kyoto Visit Discount: All visitors to our Kyoto campus will receive a ¥100,000 deduction on the Niseko entrance fee.
- Miscellaneous Fees → Summer / Winter Program (optional), clubs (optional), school supplies, etc.
- All fees are subject to change during enrollment.
- Application and entrance fees are non-refundable.
- Annual payment of tuition is available for Spring entrants only. Fall and Winter entrants must use the by-term or by-month payment options until the next academic year.
- Financial aid (case-by-case) and sibling discount are available. Please contact the school office for details. (Submit the financial aid application and related documents at the same time as your application for admission.)
- All fees must be paid by bank transfer (details will be sent along with the confirmation of admission after the prefectural approval for the school is granted.)

## STUDENT HOUSING

Six apartment units are scheduled for construction near the school, intended for high school students (grade 10 or above) seeking rental accommodation. These units will consist of single-occupancy, one-room (1R) setups furnished with essential items such as a bed, table, chair, and a small refrigerator. Each 1R apartment will span 26 square meters. Rent for these units, inclusive of utilities, will amount to 72,000 yen per month (subject to change).

To express interest in securing a 1R apartment, applicants should indicate their preference on the online pre-application form. The admissions office will communicate both the housing application outcome and the status of the student's enrollment application.

Additionally, the building will include larger apartment units specifically allocated for lease by school staff. Should any of these units remain unoccupied, families of students may have the opportunity to rent them. The school will share rental cost and further information if the availability of larger units arises. It is important to note that students in grades 1 to 9 must have a parent or adult guardian approved by their parent co-residing with the student to be eligible to apply.

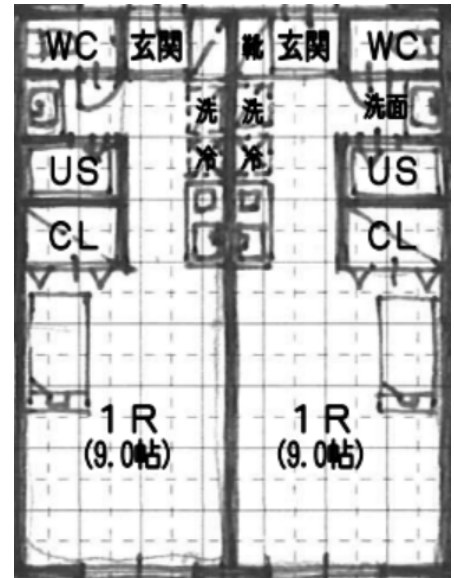

### KIU Academy Admissions Policy (Excerpt from the Parent-Student Handbook)

#### Procedure

Those interested in applying for admission should contact the Office of Admissions to request information and the application form.

Interviews and placement tests are administered (details depend on the grade level of the applicant). Results of the interview and tests, together with the content of school transcripts and application form, are considered by the school. The Office of Admissions makes a decision and the applicant is notified.

#### General Terms and Requirements

KIU Academy does not discriminate against students and parents on the basis of race, biological sex, national or ethnic origin, religion, color, or disability. Students from all backgrounds are accepted, but as a general rule students must be fluent in either Japanese or English and must demonstrate average intellectual ability. Learning disabilities must be specified in writing by a professional and include recommendations as to how the school is to support the student. A student's admission to and continued enrollment at KIU Academy are based on full disclosure of school records and known learning disabilities. Students with physical handicaps, as well as students with poor academic/behavioral records may be admitted on a provisional basis.

#### Age Requirements

To enter grade 1, a student must be six years-old at the start of the academic year (April 1). Exceptions may be granted at the discretion of the principal. Admission to grade levels beyond first grade is considered based on the applicant's

age, academic ability, maturity level and previous years of schooling.

#### Financial Aid

Financial aid may be available for families having difficulty affording tuition. Eligibility requires the release of personal financial records. Please contact the Office of Admissions for further information.

#### Tuition Refund

Tuition fees\* may be refunded if the student's guardian submits an official Notice of Withdrawal to the school office no later than six weeks prior to the beginning of a new trimester. After that, there will be no refund for that trimester. There will be no refund for application fees, entrance fees, registration fees and facilities fees. Only tuition fees that were paid in advance are eligible for refund. Refunds will be charged a 5,000 yen domestic service fee and/or a 10,000 yen international service fee in addition to all bank transfer fees. \*Tuition fees paid in one installment are recalculated as trimester installments (+5%).

#### Financial Delinquency

In the case of financial delinquency, school policy allows for the withholding of grades, transcripts, letters of reference and graduation diplomas. Students whose tuition is outstanding beyond 30 days may be barred from taking final exams and/or suspended. If payment is outstanding beyond 60 days, the student may be removed from the school roll.

### School Calendar

The [following calendar](#) is for 2024-25 at the Kyoto campus. We will announce the 2025-26 calendar for KIU - Niseko at a later time.

